

**NF8****Miniature PCB Power Relay  
1 pole 10A****Technical data****Contact data**

Type of contact	Single contact	
Configuration	1NO / 1CO	
Rated voltage	VAC	250
Rated current	A	10
Contact resistance	mΩ	≤100
Contact material	Ag alloy	

**General data**

Mechanical life	Oper.	10 <sup>7</sup>
Electrical life 10A, 250VAC, +85°C 6A, 250VAC, +105°C	Oper.	50 x 10 <sup>3</sup> 100 x 10 <sup>3</sup>
Max. Switching rate at rated load	Oper./h	360
Operating time / Release time	in ms max	≤ 10 / 5
Clearance / creepage distances	mm	≥ 1.5 / 1.8
Dielectric strength contacts / coil	VAC <sub>rms</sub>	1500
Dielectric strength open contacts	VAC <sub>rms</sub>	750
Ambient temperature	°C	-40...+105
Vibration resistance 10 ~ 55Hz double amplitude	mm	1.5
Shock resistance 11 ms	g	10
Approvals preliminary	VDE, UL/CUL, CQC	
Insulation material for domestic appliances – according IEC 60335-1		

**Coil data at +23°C**

U <sub>N</sub> (VDC)	R (Ω)	U <sub>pull-in</sub> (VDC)	U <sub>drop-out</sub> (VDC)	I <sub>N</sub> (mA)
5	70 ± 10%	≤ 3.75	≥ 0.5	71
6	100 ± 10%	≤ 4.5	≥ 0.6	60
9	225 ± 10%	≤ 6.75	≥ 0.9	40
12	400 ± 10%	≤ 9	≥ 1.2	30
18	900 ± 10%	≤ 13.5	≥ 1.8	20
24	1600 ± 10%	≤ 18	≥ 2.4	15
48	6400 ± 10%	≤ 33.6	≥ 4.8	7.5

# NF8

# Miniature PCB Power Relay 1 pole 10A



### Safety approval ratings

VDE (coils: 5, 6, 9, 12, 24 and 48VDC)	UL / CUL
10A, 250VAC, +85°C, NO contact	10A, 250VAC
6A, 250VAC, +105°C, NO contact	15A, 125VAC
6A, 400VAC, +85°C, NO contact	20A, 16VDC
CQC	
7A, 250VAC	

### Ordering Key

1.	2.	3.	4.	5.	6.	7.
NF8	100	E	-	12	-	XXXX

Character 1	Type	NF8				
Character 2	Configuration	100 = 1 NO contact 001 = 1 CO contact				
Character 3	Contact material	E = Ag alloy				
Character 4	Pinning	Nil = Standard NO terminal				
Character 5	Coil code	5 = 5VDC 12 = 12VDC 48 = 48VDC	6 = 6VDC 18 = 18VDC	9 = 9VDC 24 = 24VDC		
Character 6	Protection	Nil = Flux tight S = Sealed washable				
Character 7	Special	XXXX = Customer special				

### Ordering key, example: NF8 001 E 24

10A miniature PCB power relay, 1CO, Ag Alloy, flux tight, 24VDC coil

### Dimension (in mm):

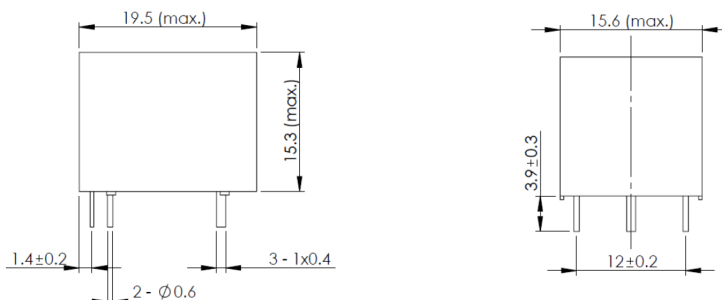

# NF8

# Miniature PCB Power Relay 1 pole 10A



Wiring / PCB-layout (Bottom view)

1NO

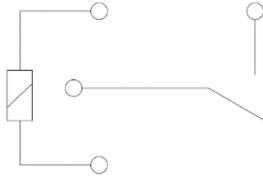

1CO

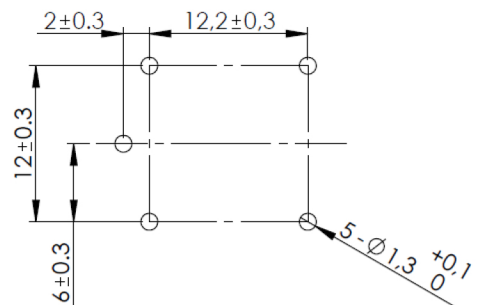
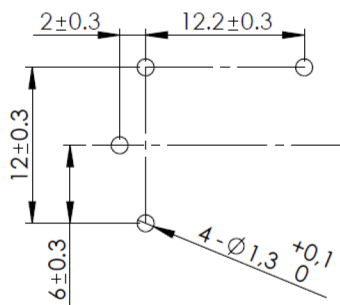
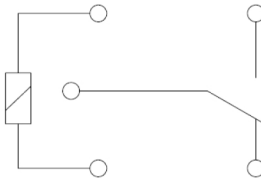

View on solder pins.  
Dimensions in mm.